

FIRST FLOOR LEVEL

Affordable and easy to build, this house plan offers a family efficient layout. The living room is highlighted by a vaulted ceiling and an open floor plan. The master suite includes a walk-in closet with a well-equipped master bath.

Rainer 1072 Ranch w/ Basement

Bedrooms	2
Bath	2
Width	60'-0"
Depth	30'-0"
1st Floor	1072 sq ft
Finished	1072 sq ft
Unfinished	1072 sq ft

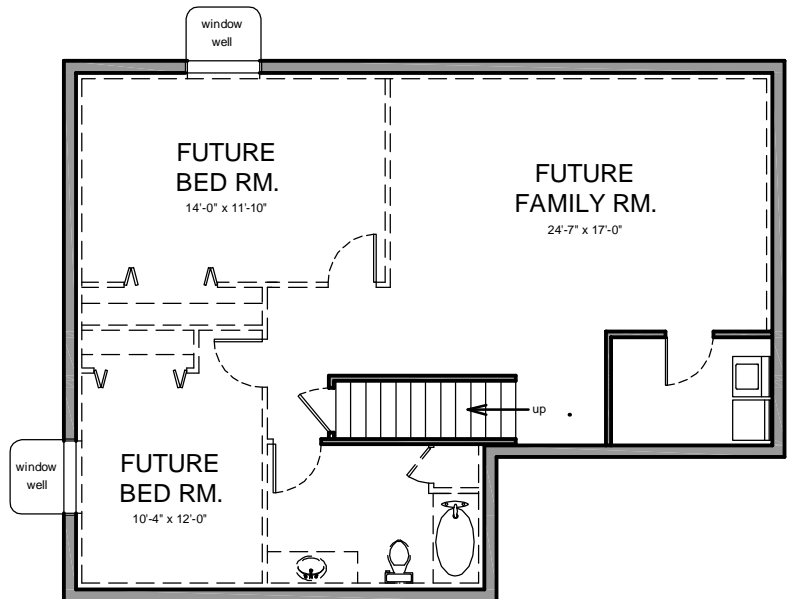

BASEMENT LEVEL

CHEYENNE
PASS.com

791-5005